



THIS DRAWING IS THE COMPUTERISED REPRODUCTION OF ORIGINAL DRAWING NO.89 JOB NO. 24 DATED 14.6.94 AND PREPARED ON 14.6.94

HARISH ROMAN DALJIT SINGH  
PREPARED BY CHECKED BY A.T.P.

AMENDMENT IN CLAUSE 2  
THE AREA FOR THE RESIDENCE OF CARETAKER HAS BEEN INCREASED FROM 9% TO 14% AS APPROVED BY THE FINANCE SECRETARY CUM CHIEF ADMINISTRATOR VIDE HIS MEMO NO. 21/1/1215-UT/91-2004/1622 DATED 10.04.2004

ROMAN DALJIT SINGH  
PLANNING OFFICER A.T.P.

NOTE:  
THIS DRAWING WAS APPROVED AND SIGNED BY THE CHIEF ADMINISTRATOR VIDE HIS OFFICE MEMO NO. 21/1/1215-UT/91-2004/1622 DATED 16-6-2004.

5/5  
A.T.P.

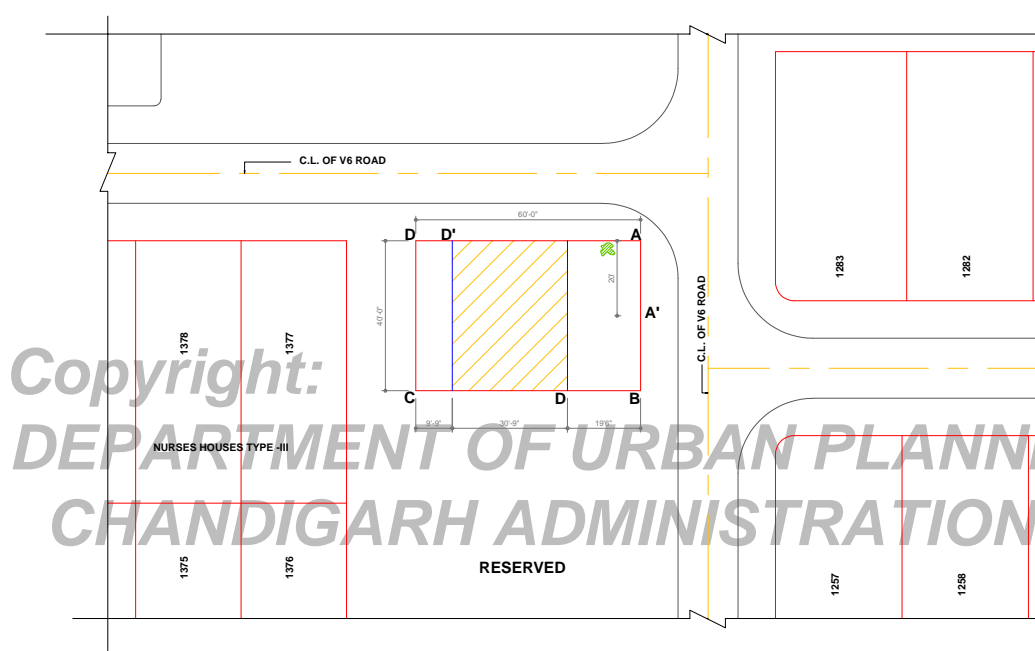

Copyright:  
DEPARTMENT OF URBAN PLANNING  
CHANDIGARH ADMINISTRATION

**1. SIZE OF THE SITE :-**

THE SITE OF "SAHAYATA CHARITABLE WELFARE SOCIETY" IN SECTOR 15-B SHALL BE 'ABCD' AS SHOWN ON THIS PLAN. THE AREA OF THE SITE SHALL BE 2400.00 SQ.FT. (266.66 SQ. YDS.)

**2. TYPE OF BUILDINGS PERMITTED :-**

THE TYPE OF BUILDINGS PERMITTED ON THE SITE FOR "SAHAYATA CHARITABLE WELFARE SOCIETY" SHALL BE FOR CENTRE FOR INFORMATION, EDUCATION, PREVENTION AND CONTROL OF CANCER ONLY AND THEIR USE FOR ANY OTHER PURPOSE IS PROHIBITED. THE RESIDENCE OF THE CARE TAKER IF BUILT SHALL NOT TOGETHER EXCEED 5% OF THE TOTAL PERMISSIBLE AREA OF THE SITE COVERAGE. THE BUILDING CONSTRUCTED ON THE SITE SHALL BE DEDICATED TO THE MANAGEMENT OF "SAHAYATA CHARITABLE WELFARE SOCIETY" AND IT SHALL NOT REMAIN THE SOLE PROPERTY OF THE DONORS TO BE CONVERTED BY THEM LATER ON TO ANY PERSONAL USE. THE BUILDINGS CONSTRUCTED ON THE SITE SHALL BE OPEN TO ALL AND THEIR USE WOULD NOT BE RESTRICTED TO ANY PARTICULAR SECT OR COMMUNITY.

**3. LAND USE :-**

THE SITE SHALL BE USED FOR THE CONSTRUCTION OF BUILDINGS FOR "SAHAYATA CHARITABLE WELFARE SOCIETY" ONLY BY THE ALLOTTEES AND CHANGE IN THE USE OF LAND FOR PURPOSES OTHER THAN THAT FOR WHICH THE SITE IS ALLOTTED SHALL NOT BE PERMITTED IN ANY CASE.

**4. SPECIAL AREA:-**

THE SITE FOR "SAHAYATA CHARITABLE WELFARE SOCIETY" IS DECLARED AS A 'SPECIAL AREA' AND THE DESIGN OF THE BUILDINGS TO BE ERRECTED THERE UPON SHALL BE PREPARED BY A DULY QUALIFIED ARCHITECT IN CONSULTATION WITH THE CHIEF ARCHITECT U.T. CHANDIGARH AND THE WORK SHALL BE EXECUTED UNDER THE SUPERVISION OF THE SAME ARCHITECT OR ANY OTHER DULY QUALIFIED ARCHITECT.

**5. SITE COVERAGE & FLOOR AREA RATIO:-**

- (a) THE BUILDING SHALL BE PERMITTED WITHIN THE PORTION OF THE SITE MARKED AS ON THIS PLAN AND NOT WHERE ELSE.
- (b) THE MAXIMUM AREA THAT MAY BE BUILT AT THE GROUND FLOOR LEVEL SHALL NOT EXCEED 960.00 SQ.FT. ( 106.66 SQ.YDS ) I.e. 40% OF THE AREA OF THE SITE.
- (c) F.A.R (FLOOR AREA RATIO) SHALL NOT EXCEED 1.00

NOTE:-THE TERM " FLOOR AREA RATIO" SHALL MEAN THE RATIO OF THE TOTAL BUILT UP AREA OF THE BUILDING ON ALL FLOORS TO AREA OF THE SITE.

**6. HEIGHT:-**

- (a) PLINTH HEIGHT OF THE BUILDING SHALL BE A MINIMUM OF 0.30MTRS.(1'3") ABOVE THE CENTRE OF THE FINISHED LEVEL OF THE STREET ADJUTING THE BOUNDARY WALL MARKED AS 'AB'

(B)THE MAXIMUM PERMISSIBLE HEIGHT OF BUILDINGS CONSTRUCTED IN THE PERMISSIBLE BUILDING ZONE MARKED AS ON THIS PLAN SHALL BE 10.5MTRS. (35'0") INCLUSIVE OF THE PARAPET AND THE MAXIMUM NUMBER OF STOREYS THAT MAY BE BUILT WITHIN THE HEIGHT OF 10.5MTRS.(35'0")SHALL NOT EXCEED THREE.

**7. BOUNDARY WALLS:-**

- (A) BOUNDARY WALLS ALONG BOUNDARIES OF THE SITE MARKED AS ' ABCD ' ON THIS PLAN SHALL BE OF THE SPECIFICATIONS AND TYPE DESIGN 'B' AS SHOWN ON DRG. NO. 5/5 AVAILABLE FROM THE CHIEF ARCHITECT ON APPLICATION.
- (B) THE HEIGHT AS APPLIED TO BOUNDARY WALL SHALL MEAN THE VERTICAL MEASUREMENT OF THE WALL FROM THE CENTRE OF THE FINISHED LEVEL OF THE STREET TO WHICH THE SITE HAS AN ACCESS.
- (C) IN CASE OF SLOPING SITES, THE PRESCRIBED HEIGHT OF A WALL MAY BE EXCEEDED OVER PORTIONS OF ITS LENGTH PROVIDED THAT AT NO POINT A HEIGHT OF MORE THAN 0.60MTRS.(2'0") ABOVE THE PRESCRIBED HEIGHT SHALL BE PERMITTED.
- (D) THE CURVATURE OF BOUNDARY WALLS ALONG CORNERS OF THE SITE SHALL BE IN ACCORDANCE WITH THE RADII INDICATED ON THIS PLAN AND ILLUSTRATED ON DRG. NO. 5/5 AVAILABLE FROM THE CHIEF ARCHITECT ON APPLICATION.

**8. GATE POSTS WITH GATES:-**

- (A) GATE POSTS AND GATES SHALL BE OF ONE OF THE TYPE DESIGNS AND SPECIFICATIONS SHOWN ON DRG.NO.5/5 READ WITH 5/6 AVAILABLE FROM THE CHIEF ARCHITECT ON APPLICATION.
- (B) ONLY ONE GATE WITH GATE POSTS SHALL BE ERRECTED ALONG THE PORTION OF BOUNDARY MARKED 'AB' ON THIS PLAN.
- (C) ONE WICKET GATE OF DESIGN 'G' SHOWN ON DRG. NO. 5/5 AVAILABLE FROM THE CHIEF ARCHITECT MAY HOWEVER BE PERMITTED ALONG THE BOUNDARY MARKED 'AD' ON THIS PLAN.

**9. BAR ON SUB-DIVISION OF SITE:-**

THE SITE FOR "SAHAYATA CHARITABLE WELFARE SOCIETY" AS SHOWN ON THIS PLAN SHALL NOT BE SUB-DIVIDED UNDER ANY CIRCUMSTANCES WHATSOEVER.

**10. PARKING:-**

ADEQUATE PARKING SPACE SHALL BE PROVIDED WITHIN THE SITE OF " SAHAYATA CHARITABLE WELFARE SOCIETY ", THE TOTAL AREA OF SUCH PARKING LOTS SHALL NOT BE LESS THAN 20% OF THE AREA OF THE SITE.

**11. DUST BIN:-**

THE DUST BIN SHALL BE OF SIZE, SPECIFICATION AND DESIGN AS SHOWN IN DRG. NO. 5/6 AVAILABLE FROM THE CHIEF ARCHITECT ON APPLICATION.

**12.WIDTH AND SLOPE OF RAMP:-**

- (a) THE CLEAR WIDTH OF THE RAMP LEADING TO THE BASEMENT SHALL NOT BE LESS THAN 4.00 M WITH AN ADEQUATE SLOPE NOT STEEPER THAN 1:10.
- (b) THE RAMP SHALL BE OF NON SLIPPERY SURFACE.
- (c) SEPARATE ENTRY / EXIT OF RAMPS IN THE BASEMENT SHALL BE PROVIDED.
- (d) ADEQUATE ARRANGEMENT SHALL BE MADE SO THAT SURFACE DRAINAGE DOES NOT ENTER INTO THE BASEMENT.
- (e) ACCESS TO THE BASEMENT SHALL BE SEPARATE FROM THE MAIN AND ALTERNATIVE STAIR CASE PROVIDING ACCESS AND EXIT FROM HIGHER FLOORS. WHERE THE STAIRCASE IS CONTINUOUS IN THE CASE OF BUILDINGS SERVED BY MORE THAN ONE STAIR CASE THE SAME SHALL BE OF ENCLOSED TYPE SERVING AS A FIRE SEPARATION FROM THE BASEMENT FLOOR AND HIGHER FLOORS.

**13.BUILDING BYE LAWS:-**

THE CONSTRUCTION OF BUILDING/BUILDINGS SHALL BE GOVERNED BY THE BUILDING RULES PROVIDED IN PART -I TO PART-V OF THE PUNJAB CAPITAL DEVELOPMENT & REGULATIONS BUILDING RULES 1952 ON THE POINTS WHERE SUCH RULES ARE SILENT AND STIPULATE NO CONDITION OR NORMS, NATIONAL BUILDING CODE OF INDIA PUBLISHED BY THE BUREAU OF INDIAN STANDARDS SHALL BE APPLICABLE.

**14. PROTECTED TREES:-**

TREES MARKED AS ON THE PLAN SHALL BE DEEMED TO BE PROTECTED TREES UNDER THE CHANDIGARH TREES PRESERVATION ORDER 1952.

**15. BASEMENT:-**

- (A) BASEMENT STOREYS IS OPTIONAL AND IT SHALL NOT BE INCLUDED IN THE F.A.R.
- (B) FLOOR AREA OF THE BASEMENT STOREY SHALL NOT EXCEED THE AREA OF THE SITE COVERAGE OF BUILDING OF WHICH IT FORMS A PART AND IT SHALL BE ALLOWED ONLY BELOW THE GROUND FLOOR OF THE BUILDING.
- (C) THE BASEMENT IF CONSTRUCTED, SHALL BE USED FOR STORAGE, PARKING, AIR-CONDITIONING PLANT AND OTHER NON-HABITABLE PURPOSES ONLY. ITS CLEAR HEIGHT FROM THE FINISHED FLOOR LEVEL TO BOTTOM OF THE BASEMENT JOISTS SHALL BE 2.20MTRS. (7'3") ONLY.

**16. GENERAL:-**

- (A) AMONG OTHER PLANS AND DOCUMENTS, DETAILED ELEVATIONS OF BUILDING ALONG ALL SIDES EXPOSED TO PUBLIC VIEW SHALL BE DRAWN TO A SCALE OF 1CM = 25CMS. AND SHALL ACCOMPANY THE BUILDING APPLICATION.
- (B) WATER STORAGE TANKS AND OTHER PLUMBINGS ETC. SHALL NOT BE EXPOSED TO PUBLIC VIEW ON ANY FACE OF THE BUILDINGS BUT SHALL BE SUTAILY ENCASED.
- (C) NO APPLIED DECORATIONS LIKE INSCRIPTIONS, CROSSES, NAME OF PERSONS OR BUILDINGS ARE PERMITTED ON ANY EXTERNAL FACE OF THE BUILDING.
- (D) THE BUILDING DESIGNS FOR MINIMUM OF 90% OF THE PERMISSIBLE COVERED AREA SHALL BE SUBMITTED AS A WHOLE AND NOT IN PARTS.
- (E) PROVISION SHOULD BE MADE FOR BARRIER FREE ENVIRONMENT FOR PHYSICALLY DISABLED.
- (F) THE ROOF TOP RAIN WATER HARVESTING SYSTEM SHALL BE PROVIDED AND SHALL BE MADE OPERATIONAL ALL THE TIME AS PROVIDED BY S.E PUBLIC HEALTH CHANDIGARH ADMINISTRATION.
- (G) THE BUILDING SHALL BE DESIGNED FOR APPROPRIATE SEISMIC LOAD, ALL DEAD & LIVE LOADS, WIND PRESSURE ETC. IN ALL CASES.NORMAL STRENGTHENING TO PESTIST DISTRESS DURING EARTH QUAKES ETC.

5/4  
CHIEF ADMINISTRATOR

5/4  
CHIEF ARCHITECT

5/4  
DIVISIONAL TOWN PLANNER

5/4  
DRAWN BY : HARISH

5/4  
CHECKED BY : ROMA

5/4  
DATE : 16/07/07

5/4  
JOB NO : 24

5/4  
DATE : 14.6.04

**ZONING PLAN OF  
SAHAYATA CHARITABLE  
WELFARE SOCIETY  
SECTOR 15**

INDICATING THE DIRECTIONS OF THE CHIEF ADMINISTRATOR ISSUED UNDER THE CAPITAL OF PUNJAB(DEVELOPMENT REGULATIONS) ACT,1952